

WINTER 2020

SELECT A FLOOR TO JUMP
TO ITS MAP

- A. [FIRST FLOOR](#)
- B. [SECOND FLOOR](#)
- C. [THIRD FLOOR](#)
- D. [FOURTH FLOOR](#)

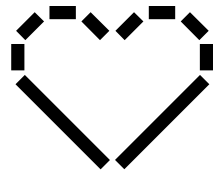

WELCOME
TO
THE MCA







We're so
glad
to see you
again!

WELCOME BACK

Below is the Code of Conduct that we all agree to in order to visit, share, and learn in the museum. By entering the space, you're agreeing:

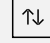
- To wear a mask.
- To use hand sanitizer after touching objects.
- To mind the signs and maintain a safe distance of 6 feet.
- To follow the visitor path marked with **blue arrows**. Take the stairs for gallery access. Elevators are available throughout, if you need.
- To stay to the right to ensure proper social distancing.
- You are not currently experiencing any symptoms related to COVID-19.
- To exit through the MCA Store.
- To be kind.

Visit mcachicago.org/safety to learn more.

KEY	
	
Info desk	Restrooms
	
Admissions	Elevator
	
ADA path	Stairwell
	
Parking garage	Staircase

GROUND FLOOR



Have questions? Ask a Visitor Experience Associate on the floor. Look for their blue lanyard!

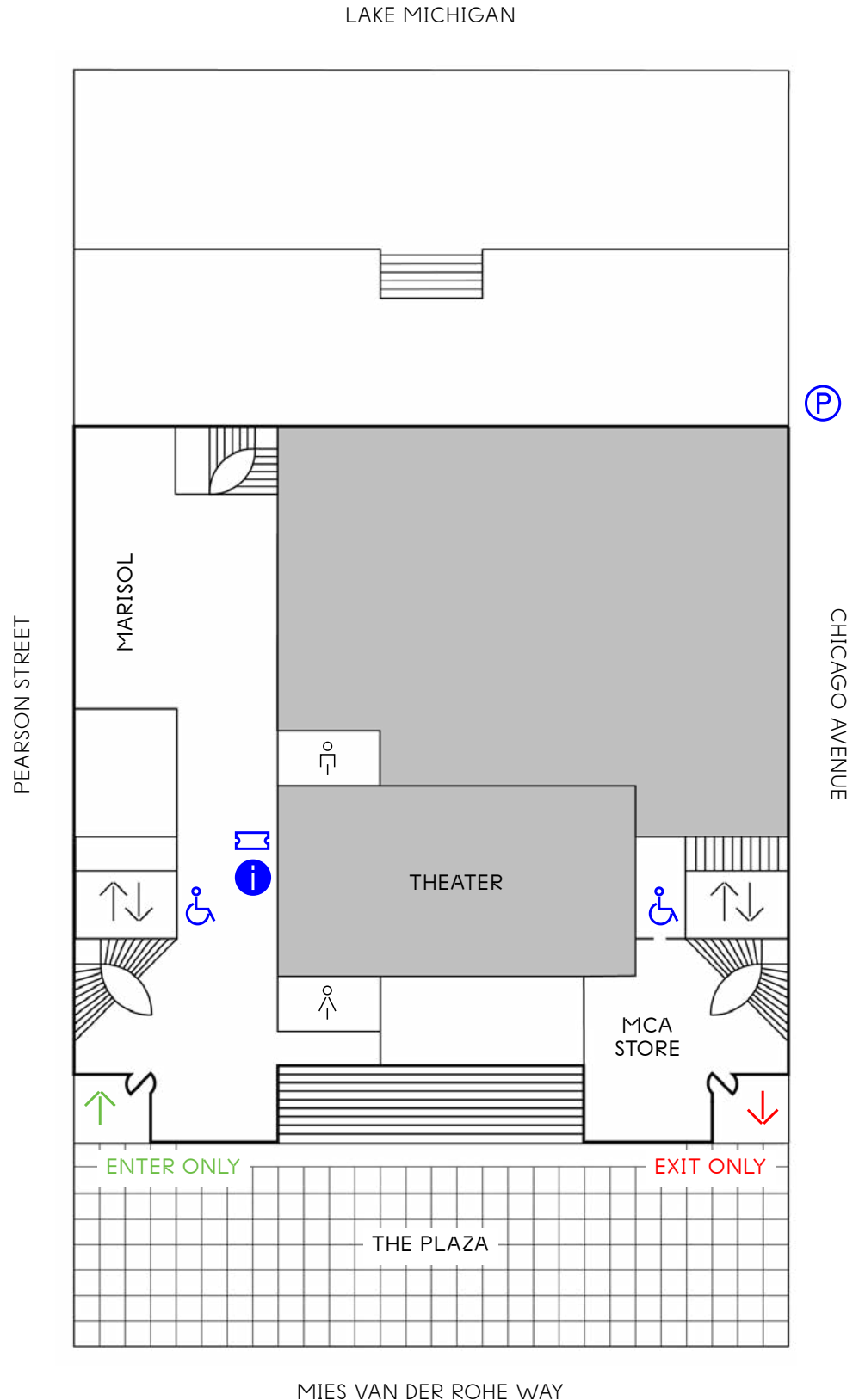

WHAT'S ON VIEW

A. [Alien vs. Citizen](#)
THROUGH FEB 21, 2021

C. [Atrium Project: Ad Minoliti](#)
THROUGH JAN 3, 2021

D. [.paint](#)
THROUGH NOV 15

[The Commons](#)

This metropolitan oasis is always free. Visit our community space by visiting the Commons Online.

[MCA Store](#)

[Sculpture Garden](#)

SECOND FLOOR



Have questions?
Ask a Visitor Experience Associate on the floor. Look for their blue lanyard!

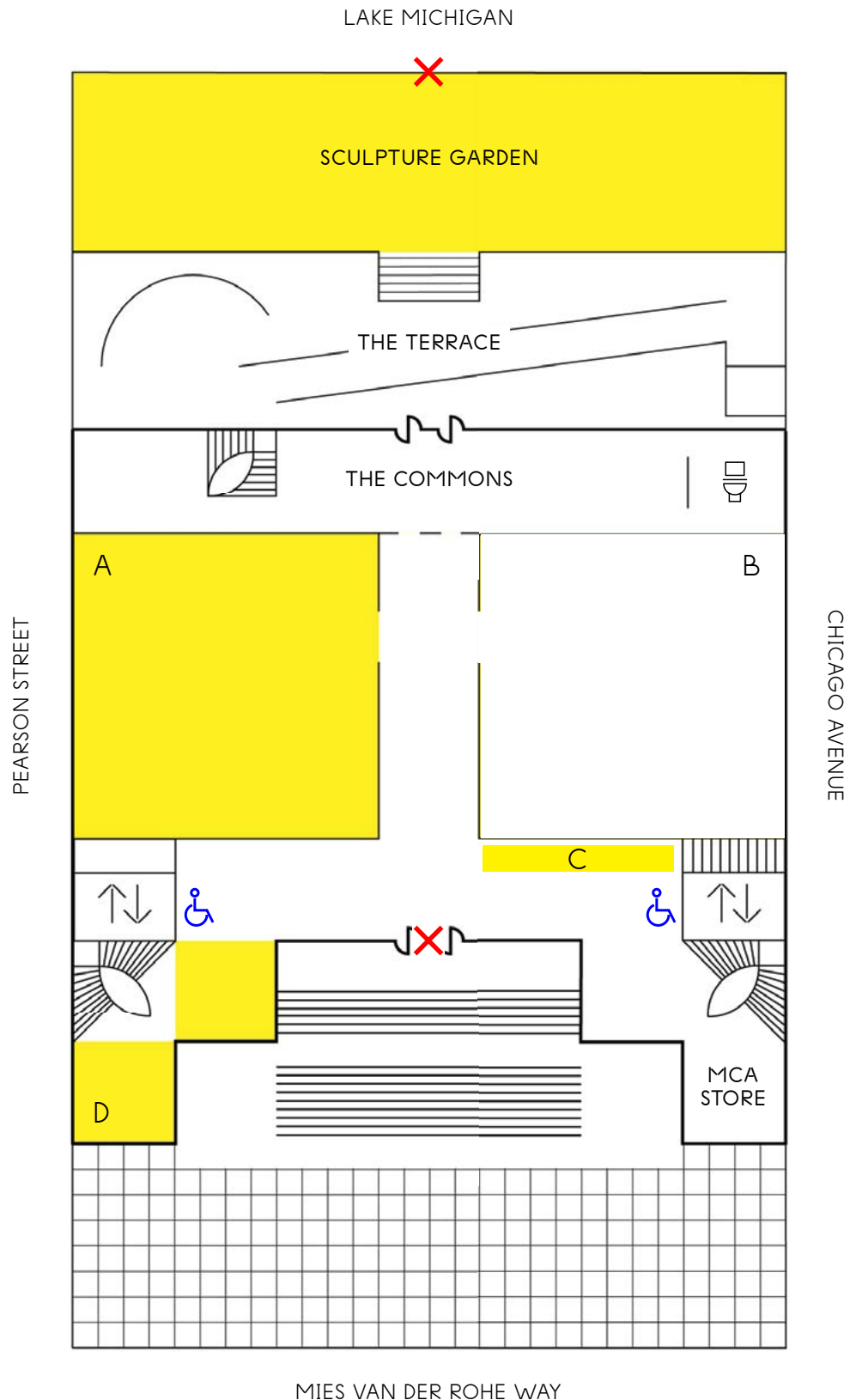

KEY

ADA path	Gender-neutral restrooms
No access	Elevator
Gallery	Stairwell
	Staircase

WHAT'S ON VIEW

THIRD FLOOR



Have questions?
Ask a Visitor Experience
Associate on the
floor. Look for their
blue lanyard!

A. [Chicago Works:
Deborah Stratman](#)
THROUGH DEC 6

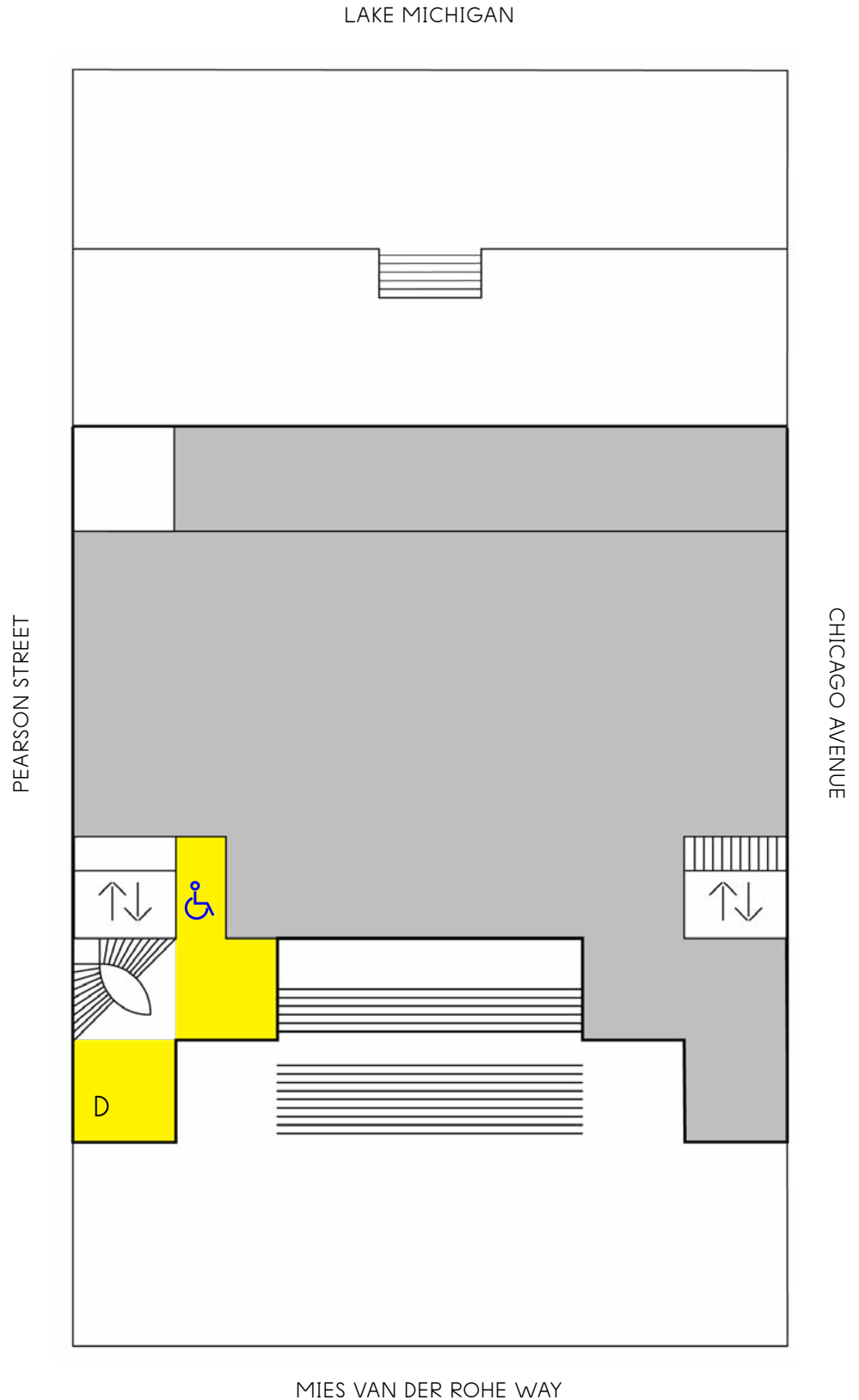

KEY

ADA path

Gallery

Elevator

Stairwell

Staircase

WHAT'S ON VIEW





- A. [The Long Dream](#)
THROUGH JAN 17, 2021
- B. [The Location of Lines](#)
THROUGH FEB 21, 2021

FOURTH FLOOR

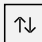

Have questions?
Ask a Visitor Experience Associate on the floor. Look for their blue lanyard!

KEY

	
ADA path	Elevator
	
Gallery	Stairwell
	
	Staircase

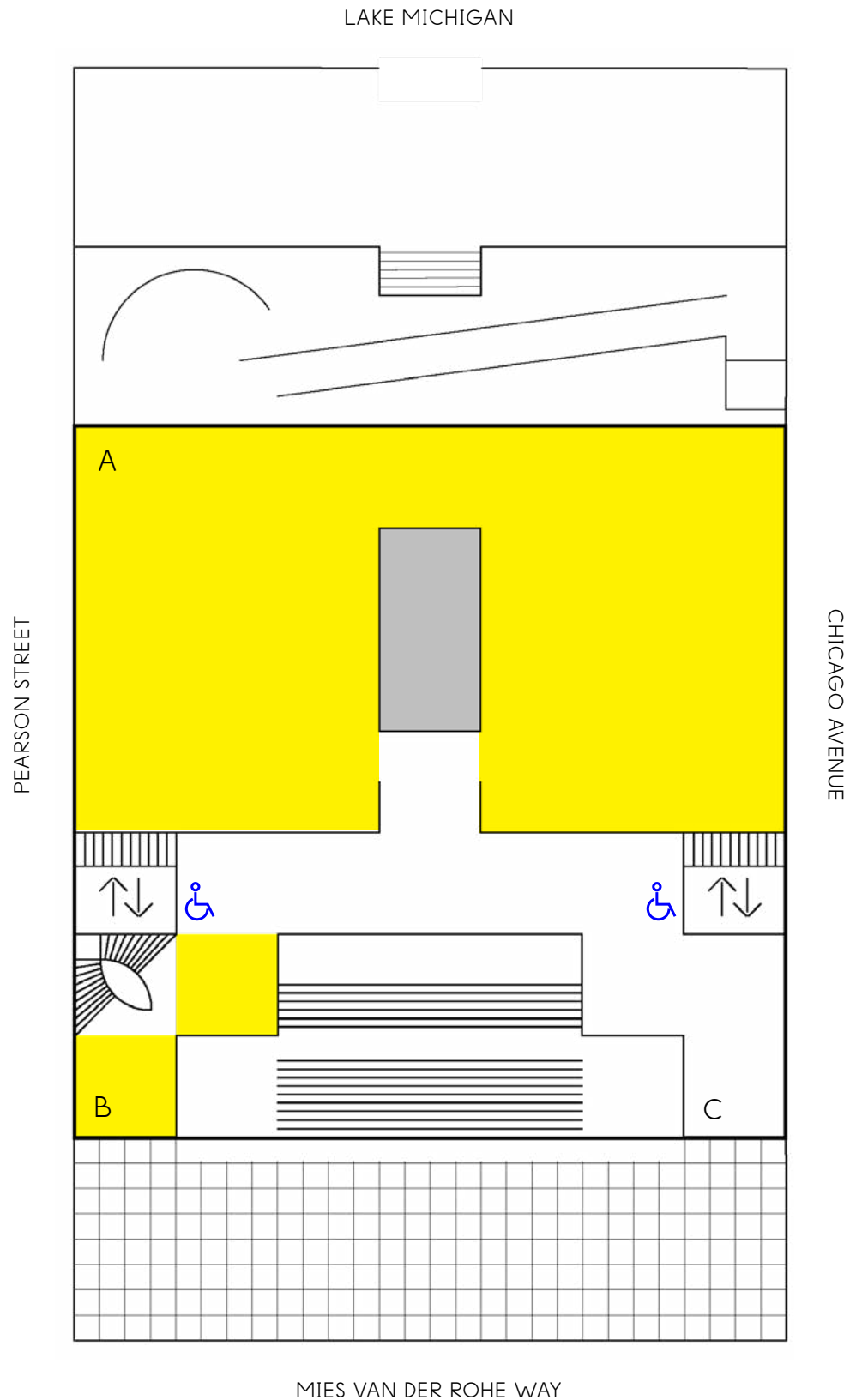

LEARN MORE

Want updates on exhibitions, programs, and more? Sign up for our newsletters or follow us on Twitter, Instagram, or Facebook.

[Twitter](#)
[Instagram](#)
[Facebook](#)

Explore our digital community space at mcachicago.org/CommonsOnline.

More about our new safety practices at mcachicago.org/Safety.

Have a question and don't see it here? Check our [FAQ page](#).

Donate at mcachicago.org/give. Your support allows us to make the museum's programs, learning resources, and collection available virtually—thank you.

NEXT

UP

Venture into humanity's relationship with nature in *Carolina Caycedo: From the Bottom of the River*, opening Dec 5.

Artist Dan Peterman's works fill the Turner Gallery, opening Dec 12.

Omar Velázquez shares new works beginning on Dec 22.